

SCALE: 1" = 400'

BASIS OF BEARING  
SURVEY BY  
MECO ENGINEERING COMPANY  
DATED 5-23-2023  
PROVIDED BY CLIENT

REFERENCE DEED  
BOOK 2023 PAGE 3072  
D.R.F.C.A.

**SURVEY DESCRIPTION OVERALL TRACT**

THE SOUTHEAST QUARTER OF THE NORTHEAST QUARTER, THE SOUTHWEST QUARTER OF THE NORTHEAST QUARTER, THE SOUTHWEST QUARTER OF THE NORTHWEST QUARTER, ALL IN SECTION 11, TOWNSHIP 21 NORTH, RANGE 5 WEST, FULTON COUNTY, ARKANSAS, MORE PARTICULARLY DESCRIBED AS FOLLOWS:

BEGINNING AT THE SOUTHEAST CORNER OF SAID SOUTHEAST QUARTER OF THE NORTHEAST QUARTER; THENCE NORTH 87°58'42" WEST, ALONG THE SOUTH LINE OF SAID SOUTHWEST QUARTER OF THE NORTHEAST QUARTER, A DISTANCE OF 1404.54 FEET TO THE SOUTHWEST CORNER OF SAID SOUTHWEST QUARTER OF THE NORTHEAST QUARTER; THENCE NORTH 87°58'42" WEST, ALONG THE SOUTH LINE OF SAID SOUTHWEST QUARTER OF THE NORTHEAST QUARTER, A DISTANCE OF 1404.53 FEET TO THE SOUTHWEST CORNER OF SAID SOUTHWEST QUARTER OF THE NORTHEAST QUARTER; THENCE SOUTH 87°58'42" EAST, ALONG THE SOUTH LINE OF SAID SOUTHWEST QUARTER OF THE NORTHEAST QUARTER, A DISTANCE OF 899.43 FEET TO THE SOUTHWEST CORNER OF SAID SOUTHWEST QUARTER OF THE NORTHEAST QUARTER; THENCE NORTH 02°45'12" EAST, LEAVING SAID SOUTH LINE, A DISTANCE OF 1341.50 FEET TO A POINT ON THE NORTH LINE OF SAID SOUTHWEST QUARTER OF THE NORTHEAST QUARTER; THENCE SOUTH 87°49'06" EAST, ALONG SAID NORTH LINE, A DISTANCE OF 886.65 FEET TO THE NORTHWEST QUARTER OF THE NORTHWEST QUARTER; THENCE NORTH 02°45'12" EAST, LEAVING SAID SOUTH LINE, A DISTANCE OF 1399.93 FEET TO THE CORNER OF SAID SOUTHWEST QUARTER OF THE NORTHEAST QUARTER; THENCE SOUTH 87°48'57" EAST, ALONG THE NORTH LINE OF SAID SOUTHWEST QUARTER OF THE NORTHEAST QUARTER, A DISTANCE OF 1399.93 FEET TO THE NORTHWEST CORNER OF SAID SOUTHWEST QUARTER OF THE NORTHEAST QUARTER; THENCE SOUTH 87°48'57" EAST, ALONG THE NORTH LINE OF SAID SOUTHWEST QUARTER OF THE NORTHEAST QUARTER, A DISTANCE OF 1408.32 FEET TO THE NORTHWEST CORNER OF SAID SOUTHWEST QUARTER OF THE NORTHEAST QUARTER; THENCE SOUTH 02°10'22" WEST, ALONG THE EAST LINE OF SAID SOUTHWEST QUARTER OF THE NORTHEAST QUARTER, A DISTANCE OF 1330.96 FEET TO THE POINT OF BEGINNING, CONTAINING 113.56 ACRES.

**POINT OF BEGGING**

**TRACT 13 AND TRACT 15**  
FOUND 1/2" REBAR WITH PLASTIC CAP #1415 CENTER NORTH 1/16 SECTION 11 T-21-N R-5-W  
10" WHITE OAK S68°W 23.5'  
10" HICKORY N17°E 2.4'

**POINT OF BEGGING**

**TRACT 7**  
FOUND 1/2" REBAR WITH PLASTIC CAP #1415 NORTHEAST 1/16 SECTION 11 T-21-N R-5-W  
16" BLACK OAK S55°E 7.1'  
6" HICKORY N87°W 27.3'

**POINT OF BEGGING**

**TRACT 5**  
FOUND 1/2" REBAR WITH PLASTIC CAP #1415 NORTHEAST 1/16 SECTION 11 T-21-N R-5-W  
16" BLACK OAK S55°E 7.1'  
6" HICKORY N87°W 27.3'

**POINT OF BEGGING**

**TRACT 3**  
FOUND MOUND OF STONES NORTH 1/16 SECTIONS 11 & 12 T-21-N R-5-W  
FOUND 1/2" REBAR N 01°56'44" E 31.6'

**LEGEND**

- SET OR FOUND 1/2" REBAR WITH PLASTIC ID CAP FOUND AS NOTED
- COMPUTED CORNER
- TRACT BOUNDARY LINE
- TIE LINE
- FENCE LINE
- D.R.F.C.A.
- DEED RECORDS FULTON COUNTY ARKANSAS
- S.R.F.C.A.
- SURVEY RECORDS FULTON COUNTY ARKANSAS
- POB POINT OF BEGINNING

**NOTES:**

1. LOT LINE DISTANCES ARE TO THE CENTERLINE OF THE EASEMENT
2. CORNERS SET ON THE INTERSECTION OF LOT LINES AND EASEMENT LINE

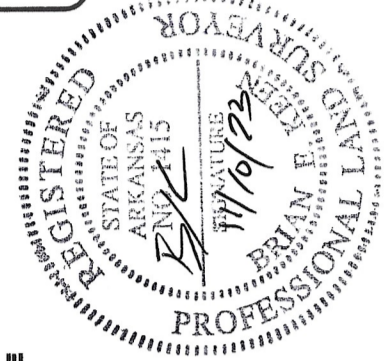

CURVE	RADIUS	ARC LENGTH	CHORD BEARING	CHORD LENGTH
C1	80.00'	80.40'	N 78°50'57" W	77.06'

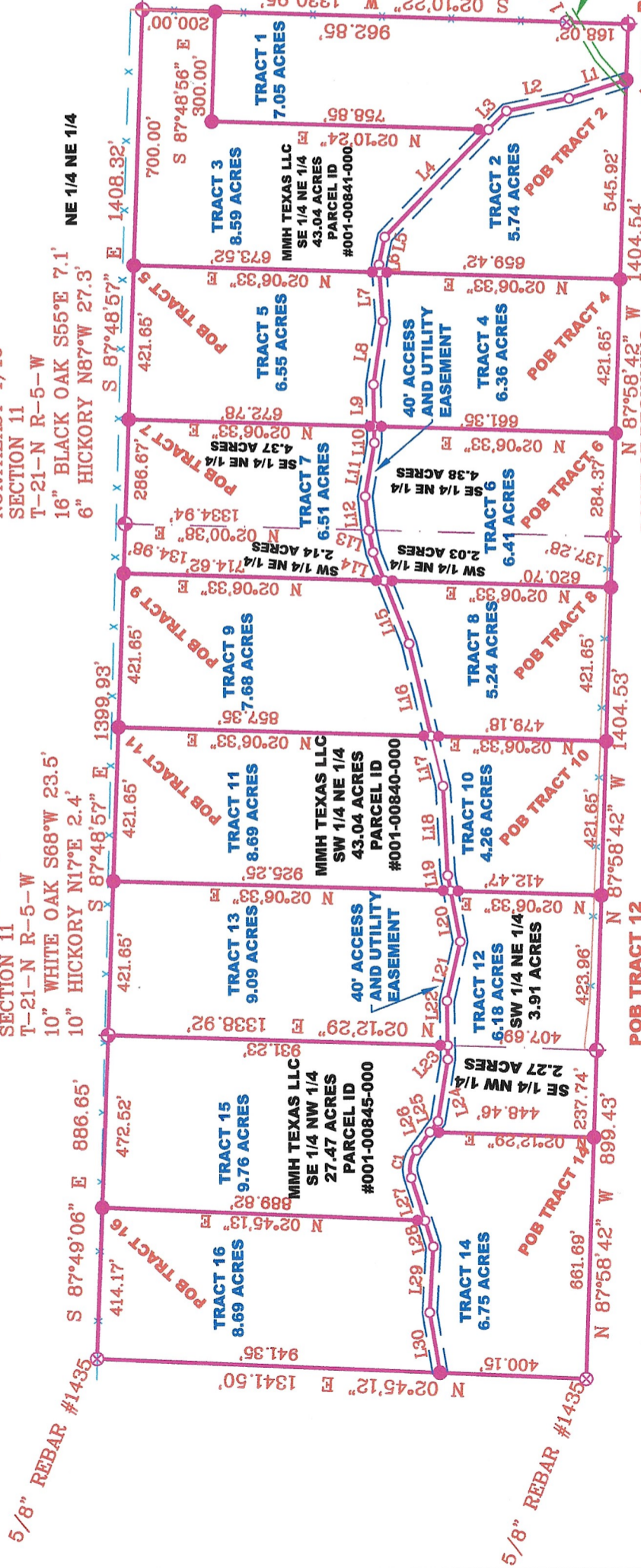

- GENERAL NOTES**
1. NO SEARCH OF PUBLIC RECORDS HAD BEEN COMPLETED BY KEEN SURVEYING, LLC TO DETERMINE ANY DEFECTS AND/OR AMBIGUITIES IN THE TITLE OF THE PARENT PARCEL
  2. THIS PROPERTY IS SUBJECT TO ANY RECORDED EASEMENTS AND/OR RIGHT OF WAYS SHOWN HERE OR NOT

LINE	BEARING	DISTANCE
L1	N 17°19'15" W	164.05'
L2	N 11°07'56" W	174.80'
L3	N 45°35'42" W	71.13'
L4	N 45°35'42" W	407.59'
L5	N 77°52'51" W	78.08'
L6	S 86°28'26" W	20.43'
L7	S 86°28'26" W	194.61'
L8	N 81°21'39" W	175.19'
L9	S 89°22'58" W	113.77'
L10	S 89°22'58" W	45.44'
L11	N 80°06'39" W	149.30'
L12	S 83°59'36" W	93.14'
L13	S 79°32'15" W	61.20'
L14	S 68°49'49" W	83.16'
L15	S 68°49'49" W	186.00'
L16	S 76°47'53" W	260.02'
L17	S 76°47'53" W	140.39'
L18	S 87°11'37" W	245.76'
L19	S 79°33'24" W	42.41'
L20	N 77°05'10" W	141.03'
L21	S 79°33'24" W	166.30'
L22	S 89°19'17" W	122.38'
L23	S 89°19'17" W	37.71'
L24	N 80°41'57" W	171.12'
L25	N 53°19'32" W	36.70'
L26	N 53°19'32" W	62.32'
L27	S 72°21'34" W	123.05'
L28	S 72°21'34" W	74.41'
L29	N 86°44'09" W	179.96'
L30	S 80°32'51" W	168.19'

MAP PREPARED FOR:  
CLASSIC COUNTRY LAND  
PAGE 1 OF 3

KEEN SURVEYING, LLC  
208 SOUTH MAIN STREET P.O. BOX 248  
SALEM, ARKANSAS 72576  
TEL (870) 886-3900 FAX (870) 886-9814  
EMAIL: BRN@KEENSURVEYING.COM  
WWW.KEENSURVEYING.COM

DATE: 11-10-23  
SCALE: 1" = 400'  
DRAWN BY: D.JONES  
CHECKED BY: B.KEEN  
JOB #1769.1021073

500-19N-06W-0-5-401-25-1415

**Tract 1 Survey Description**

Part of the Southeast Quarter of the Northeast Quarter, Section 11, Township 21 North, Range 5 West, Fulton County, Arkansas, more particularly described as follows:  
Beginning at the Southeast corner of said Southeast Quarter of the Northeast Quarter; thence North 87°58'42" West, along the South line of said Southeast Quarter of the Northeast Quarter, a distance of 152.60 feet; thence North 17°19'15" West, leaving said South line, a distance of 164.05 feet; thence North 11°07'56" West, a distance of 174.80 feet; thence North 45°35'42" West, a distance of 71.13 feet; thence North 02°10'24" East, a distance of 758.85 feet; thence South 87°48'56" East, a distance of 300.00 feet to a point on the East line of said Southeast Quarter of the Northeast Quarter; thence South 02°10'22" West, a distance of 1130.95 feet to the Point of Beginning, containing 7.05 Acres, more or less.

**Tract 2 Survey Description**

Part of the Southeast Quarter of the Northeast Quarter, Section 11, Township 21 North, Range 5 West, Fulton County, Arkansas, more particularly described as follows:  
Commencing at the Southeast corner of said Southeast Quarter of the Northeast Quarter; thence North 87°58'42" West, along the South line of said Southeast Quarter of the Northeast Quarter, a distance of 152.60 feet to the Point of Beginning; thence North 87°58'42" West, along said South line, a distance of 545.92 feet; thence North 02°06'33" East, leaving said South line, a distance of 659.42 feet; thence North 86°28'26" East, a distance of 20.43 feet; thence South 77°52'51" East, a distance of 78.06 feet; thence South 45°35'42" East, a distance of 407.59 feet; thence South 45°35'42" East, a distance of 71.13 feet; thence South 11°07'56" East, a distance of 174.80 feet; thence South 17°19'15" East, a distance of 164.05 feet to the Point of Beginning, containing 5.74 Acres, more or less.

**Tract 3 Survey Description**

Part of the Southeast Quarter of the Northeast Quarter, Section 11, Township 21 North, Range 5 West, Fulton County, more particularly described as follows:  
Beginning at the Northeast corner of said Southeast Quarter of the Northeast Quarter; thence South 02°10'22" West, along the East line of said Southeast Quarter of the Northeast Quarter, a distance of 200.00 feet; thence North 87°48'56" West, leaving said East line, a distance of 300.00 feet; thence South 02°10'24" West, a distance of 758.85 feet; thence North 45°35'42" West, a distance of 407.59 feet; thence North 77°52'51" West, a distance of 78.06 feet; thence South 86°28'26" West, a distance of 20.43 feet; thence North 02°06'33" East, a distance of 673.52 feet to a point on the North line of said Southeast Quarter of the Northeast Quarter; thence South 87°48'57" East, along said North line, a distance of 700.00 feet to the Point of Beginning, containing 8.59 Acres, more or less.

**Tract 4 Survey Description**

Part of the Southeast Quarter of the Northeast Quarter, Section 11, Township 21 North, Range 5 West, Fulton County, Arkansas, more particularly described as follows:  
Commencing at the Southeast corner of said Southeast Quarter of the Northeast Quarter; thence North 87°58'41" West, along the South line of said Southeast Quarter of the Northeast Quarter, a distance of 698.52 feet to the Point of Beginning; thence North 87°58'42" West, along said South line, a distance of 421.65 feet; thence North 02°06'33" East, leaving said South line, a distance of 661.35 feet; thence North 89°22'58" East, a distance of 113.77 feet; thence South 81°21'39" East, a distance of 175.19 feet; thence North 86°28'26" East, a distance of 134.61 feet; thence South 02°06'33" West, a distance of 659.42 feet to the Point of Beginning, containing 6.36 Acres, more or less.

**Tract 5 Survey Description**

Part of the Southeast Quarter of the Northeast Quarter, Section 11, Township 21 North, Range 5 West, Fulton County, Arkansas, more particularly described as follows:  
Commencing at the Northeast corner of said Southeast Quarter of the Northeast Quarter; thence North 87°48'57" West, along the North line of said Southeast Quarter of the Northeast Quarter, a distance of 700.00 feet to the Point of Beginning; thence South 02°06'33" West, leaving said North line, a distance of 673.52 feet; thence South 86°28'26" West, a distance of 134.61 feet; thence North 81°21'39" West, a distance of 175.19 feet; thence South 89°22'58" West, a distance of 113.77 feet; thence North 02°06'33" East, a distance of 672.78 feet to a point on the North line of said Southeast Quarter of the Northeast Quarter; thence South 87°48'57" East, along said North line, a distance of 421.65 feet to the Point of Beginning, containing 6.55 Acres, more or less.

**Tract 6 Survey Description**

Part of the Southeast Quarter of the Northeast Quarter and part of the Southwest Quarter of the Northeast Quarter, all in Section 11, Township 21 North, Range 5 West, Fulton County, Arkansas, more particularly described as follows:  
Beginning at the Southeast corner of said Southwest Quarter of the Northeast Quarter; thence North 87°58'42" West, along the South line of said Southwest Quarter of the Northeast Quarter, a distance of 137.28 feet; thence North 02°06'33" East, leaving said South line, a distance of 620.70 feet; thence North 68°49'49" East, a distance of 83.16 feet; thence North 79°32'15" East, a distance of 61.20 feet; thence North 83°59'36" East, a distance of 93.14 feet; thence South 80°06'39" East, a distance of 149.30 feet; thence North 89°22'58" East, a distance of 45.44 feet; thence South 02°06'33" West, a distance of 661.35 feet to a point on the South line of said Southeast Quarter of the Northeast Quarter; thence North 87°58'42" West, along said South line, a distance of 284.37 feet to the Point of Beginning, containing 6.41 Acres, more or less.

**Tract 7 Survey Description**

Part of the Southeast Quarter of the Northeast Quarter and part of the Southwest Quarter of the Northeast Quarter, all in Section 11, Township 21 North, Range 5 West, Fulton County, Arkansas, more particularly described as follows:  
Beginning at the Northeast corner of said Southeast Quarter of the Northeast Quarter; thence South 87°48'57" West, along the North line of said Southeast Quarter of the Northeast Quarter, a distance of 286.67 feet; thence South 02°06'33" West, leaving said North line, a distance of 672.78 feet; thence South 89°22'58" West, a distance of 45.44 feet; thence North 80°06'39" West, a distance of 149.30 feet; thence South 83°59'36" West, a distance of 93.14 feet; thence South 79°32'15" West, a distance of 61.20 feet; thence South 68°49'49" West, a distance of 83.16 feet; thence North 02°06'33" East, a distance of 672.78 feet to a point on the North line of said Southwest Quarter of the Northeast Quarter; thence South 87°48'57" West, along said North line, a distance of 134.98 feet to the Point of Beginning, containing 6.51 Acres, more or less.

**Tract 8 Survey Description**

Part of the Southwest Quarter of the Northeast Quarter, Section 11, Township 21 North, Range 5 West, Fulton County, Arkansas, more particularly described as follows:  
Commencing at the Southeast corner of said Southwest Quarter of the Northeast Quarter; thence North 87°58'42" West, along the South line of said Southwest Quarter of the Northeast Quarter, a distance of 137.28 feet to the Point of Beginning; thence North 87°58'42" West, along said South line, a distance of 421.65 feet; thence North 02°06'33" East, leaving said South line, a distance of 479.18 feet; thence North 76°47'53" East, a distance of 260.02 feet; thence North 68°49'49" East, a distance of 186.00 feet; thence South 02°06'33" West, a distance of 620.70 feet to the Point of Beginning, containing 5.24 Acres, more or less.

**Tract 9 Survey Description**

Part of the Southwest Quarter of the Northeast Quarter, Section 11, Township 21 North, Range 5 West, Fulton County, Arkansas, more particularly described as follows:  
Commencing at the Northeast corner of said Southwest Quarter of the Northeast Quarter; thence North 87°48'57" West, along the North line of said Southwest Quarter of the Northeast Quarter, a distance of 134.98 feet to the Point of Beginning; thence South 02°06'33" West, leaving said North line, a distance of 714.62 feet; thence South 68°49'49" West, a distance of 186.00 feet; thence South 76°47'53" West, a distance of 260.02 feet; thence North 02°06'33" East, a distance of 857.35 feet to a point on the North line of said Southwest Quarter of the Northeast Quarter; thence South 87°48'57" East, along said North line, a distance of 421.65 feet to the Point of Beginning, containing 7.68 Acres, more or less.

**Tract 10 Survey Description**

Part of the Southwest Quarter of the Northeast Quarter, Section 11, Township 21 North, Range 5 West, Fulton County, Arkansas, more particularly described as follows:  
Commencing at the Southeast corner of said Southwest Quarter of the Northeast Quarter; thence North 87°58'42" West, along the South line of said Southwest Quarter of the Northeast Quarter, a distance of 568.93 feet to the Point of Beginning; thence North 87°58'42" West, along said South line, a distance of 421.65 feet; thence North 02°06'33" East, a distance of 412.47 feet; thence North 79°33'24" East, a distance of 42.41 feet; thence North 87°11'37" East, a distance of 245.76 feet; thence North 76°47'53" East, a distance of 140.39 feet; thence South 02°06'33" West, a distance of 479.18 feet to the Point of Beginning, containing 4.26 Acres, more or less.

FILED DAVID  
2023-5204  
11/17/2023  
10:32 AM  
VICKIE BISHOP  
Circuit Clerk  
FULTON County, AR  
Ref 3  
Vickie Bishop

**RECORDING INFORMATION**



MAP PREPARED FOR  
CLASSIC COUNTRY LAND  
PAGE 2 OF 3



KEEN SURVEYING, LLC  
203 SOUTH MAIN STREET, P.O. BOX 226  
SALIDA, ARKANSAS 72578  
TEL: (870) 886-3600 FAX: (870) 886-3814  
EMAIL: BR@KEENSURVEYING.COM  
WWW.KEENSURVEYING.COM

DATE: 11-10-23  
SCALE: 1" = 400'  
DRAWN BY: D.JONES  
CHECKED BY: B.KEEN  
JOB #1769.1021013

**Tract 11 Survey Description**

Part of the Southwest Quarter of the Northeast Quarter, Section 11, Township 21 North, Range 5 West, Fulton County, Arkansas, more particularly described as follows;  
Commencing at the Northeast corner of said Southwest Quarter of the Northeast Quarter; thence North 87°48'57" West, along the North line of said Southwest Quarter of the Northeast Quarter, a distance of 556.63 feet to the Point of Beginning; thence South 02°06'33" West, leaving said North line, a distance of 857.35 feet; thence South 76°47'53" West, a distance of 140.39 feet; thence South 87°11'37" West, a distance of 245.76 feet; thence South 79°33'24" West, a distance of 42.41 feet; thence North 02°06'33" East, a distance of 925.25 feet to a point on the North line of said Southwest Quarter of the Northeast Quarter; thence South 87°48'57" East, along said North line, a distance of 421.65 feet to the Point of Beginning, containing 8.69 Acres, more or less.

**Tract 12 Survey Description**

Part of the Southwest Quarter of the Northeast Quarter and part of the Southeast Quarter of the Northwest Quarter, all in Section 11, Township 21 North, Range 5 West, Fulton County, Arkansas, more particularly described as follows;  
Beginning at the Southeast corner of said Southeast Quarter of the Northwest Quarter; thence North 87°58'42" West, along the South line of said Southeast Quarter of the Northwest Quarter, a distance of 237.74 feet; thence North 02°12'29" East, leaving said South line, a distance of 448.46 feet; thence South 53°19'32" East, a distance of 36.70 feet; thence South 80°41'57" East, a distance of 171.12 feet; thence North 89°19'17" East, a distance of 37.71 feet; thence North 89°19'17" East, a distance of 122.38 feet; thence South 77°05'10" East, a distance of 166.30 feet; thence North 79°33'24" East, a distance of 141.03 feet; thence South 02°06'33" West, a distance of 412.47 feet to a point on the South line of said Southwest Quarter of the Northeast Quarter; thence North 87°58'42" West, along said South line, a distance of 423.95 feet to the Point of Beginning, containing 6.18 Acres, more or less.

**Tract 13 Survey Description**

Part of the Southwest Quarter of the Northeast Quarter, Section 11, Township 21 North, Range 5 West, Fulton County, Arkansas, more particularly described as follows;  
Beginning at the Northwest corner of said Southwest Quarter of the Northeast Quarter; thence South 87°48'57" East, along the North line of said Southwest Quarter of the Northeast Quarter, a distance of 421.65 feet; thence South 02°06'33" West, leaving said North line, a distance of 925.25 feet; thence South 79°33'24" West, a distance of 141.03 feet; thence North 77°05'10" West, a distance of 166.30 feet; thence South 89°19'17" West, a distance of 122.38 feet; thence North 02°12'29" East, a distance of 931.23 feet to the Point of Beginning, containing 9.09 Acres, more or less.

**Tract 14 Survey Description**

Part of the Southeast Quarter of the Northwest Quarter, Section 11, Township 21 North, Range 5 West, Fulton County, Arkansas, more particularly described as follows;  
Commencing at the Southeast corner of said Southeast Quarter of the Northwest Quarter; thence North 87°58'42" West, along the South line of said Southeast Quarter of the Northwest Quarter, a distance of 237.74 feet to the Point of Beginning; thence North 87°58'42" West, along said South line, a distance of 661.69 feet; thence North 02°45'12" East, leaving said South line, a distance of 400.15 feet; thence North 80°32'51" East, a distance of 168.19 feet; thence South 86°44'09" East, a distance of 179.96 feet; thence North 72°21'34" East, a distance of 74.41 feet; thence North 72°21'34" East, a distance of 123.05 feet; thence along a curve to the right, having a Radius of 80.00 feet, an Arc Length of 80.40 feet and a Chord which bears South 78°50'57" East, a distance of 77.06 feet; thence South 53°19'32" East, a distance of 62.32 feet; thence South 02°12'29" West, a distance of 448.46 feet to the Point of Beginning, containing 6.75 Acres, more or less.

**Tract 15 Survey Description**

Part of the Southeast Quarter of the Northwest Quarter, Section 11, Township 21 North, Range 5 West, Fulton County, Arkansas, more particularly described as follows;  
Beginning at the Northeast corner of said Southeast Quarter of the Northwest Quarter; thence South 02°12'29" West, along the East line of said Southeast Quarter of the Northwest Quarter, a distance of 931.23 feet; thence South 89°19'17" West, leaving said East line, a distance of 37.71 feet; thence North 80°41'57" West, a distance of 171.12 feet; thence North 53°19'32" West, a distance of 36.70 feet; thence North 53°19'32" West, a distance of 62.32 feet; thence along a curve to the left, having a Radius of 80.00 feet, an Arc Length of 80.40 feet and a Chord which bears North 78°50'57" West, a distance of 77.06 feet; thence South 72°21'34" West, a distance of 123.05 feet; thence North 02°45'13" East, a distance of 889.82 feet to a point on the North line of said Southeast Quarter of the Northwest Quarter; thence South 87°49'06" East, along said North line, a distance of 472.50 feet to the Point of Beginning, containing 9.76 Acres, more or less.

**Tract 16 Survey Description**

Part of the Southeast Quarter of the Northwest Quarter, Section 11, Township 21 North, Range 5 West, Fulton County, Arkansas, more particularly described as follows;  
Commencing at the Northeast corner of said Southeast Quarter of the Northwest Quarter; thence South 87°49'06" East, along the North line of said Southeast Quarter of the Northwest Quarter, a distance of 472.52 feet to the Point of Beginning; thence South 02°45'13" West, leaving said North line, a distance of 889.82 feet; thence South 72°21'34" West, a distance of 74.41 feet; thence North 86°44'09" West, a distance of 179.96 feet; thence South 80°32'51" West, a distance of 168.19 feet; thence North 02°45'12" East, a distance of 941.35 feet to a point on the North line of said Southeast Quarter of the Northwest Quarter; thence South 87°49'06" East, along said North, a distance of 414.15 feet to the Point of Beginning, containing 8.69 Acres, more or less.

**40' Wide Access and Utility Easement**

Part of the Southeast Quarter of the Northeast Quarter and Part of the Southwest Quarter of the Northeast Quarter and Part of the Southeast Quarter of the Northwest Quarter, all in Section 11, Township 21 North, Range 5 West, Fulton County, Arkansas, more particularly described as follows;

Commencing at the Southeast corner of said Southeast Quarter of the Northeast Quarter; thence North 87°58'42" West, along the South line of said Southeast Quarter of the Northeast Quarter, a distance of 152.60 feet to the Point of Beginning of a 40 foot Wide Access and Utility Easement lying 20 feet each side of the following described centerline; thence North 17°19'15" West, a distance of 164.05 feet; thence North 11°07'56" West, a distance of 174.80 feet; thence North 45°35'42" West, a distance of 478.72 feet; thence North 77°52'51" West, a distance of 78.06 feet; thence South 86°28'26" West, a distance of 20.43 feet; thence South 86°28'26" West, a distance of 134.61 feet; thence North 81°21'39" West, a distance of 175.19 feet; thence South 89°22'58" West, a distance of 113.77 feet; thence South 89°22'58" West, a distance of 45.44 feet; thence North 80°06'39" West, a distance of 149.30 feet; thence South 83°59'36" West, a distance of 93.14 feet; thence South 79°32'15" West, a distance of 61.20 feet; thence South 68°49'49" West, a distance of 83.16 feet; thence South 68°49'49" West, a distance of 166.00 feet; thence South 76°47'53" West, a distance of 260.02 feet; thence South 76°47'53" West, a distance of 140.39 feet; thence South 87°11'37" West, a distance of 245.76 feet; thence South 79°33'24" West, a distance of 42.41 feet; thence South 79°33'24" West, a distance of 141.03 feet; thence North 77°05'10" West, a distance of 166.30 feet; thence South 89°19'17" West, a distance of 122.38 feet; thence South 89°19'17" West, a distance of 37.71 feet; thence North 80°41'57" West, a distance of 171.12 feet; thence North 53°19'32" West, a distance of 36.70 feet; thence North 53°19'32" West, a distance of 62.32 feet; thence along a curve to the left, having a Radius of 80.00 feet, an Arc Length of 80.40 feet and a Chord which bears North 78°50'57" West, a distance of 77.06 feet; thence South 72°21'34" West, a distance of 197.46 feet; thence North 86°44'09" West, a distance of 179.96 feet; thence South 80°32'51" West, a distance of 168.19 feet to the Point of Termination.

FILED Doc ID:  
2023-5204  
11/17/2023  
10:32 AM  
VICKIE BISHOP  
Circuit Clerk  
FULTON County, AR  
3 of 3  
Vickie Bishop

**RECORDING INFORMATION**



MAP PREPARED FOR  
CLASSIC COUNTRY LAND  
PAGE 3 OF 3

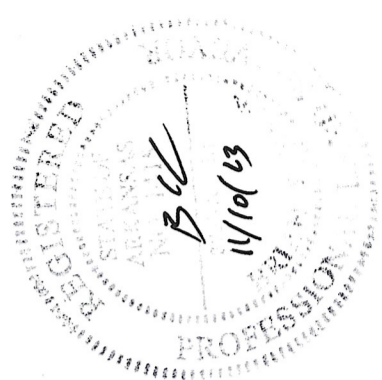

KEEN SURVEYING, LLC  
283 SOUTH MAIN STREET, P.O. BOX 245  
STATEVILLE, ARKANSAS 72574  
TEL (870) 885-9800 FAX (870) 885-3414  
EMAIL: BRIAN@KEENSURVEYING.COM  
WWW.KEENSURVEYING.COM

DATE: 11-10-23  
SCALE: 1" = 400'  
DRAWN BY: D.JONES  
CHECKED BY: B.KEEN  
JOB #1769.102LOTS